

Bearings - Rear Wheel - Inner and Outer - Renew (hub assembly removed) (15 413 4)

Special Tools

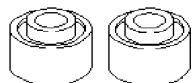

14034

14-034 Installer, wheel bearings



1403801

14-038-01 Thrust pad, wheel hub,

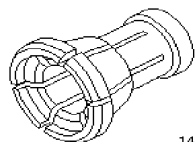

14038

14-038 Collet for 15-050A, wheel bearing

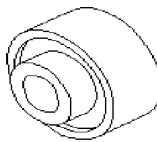

14040

14-040 Installer, wheel bearing



1503301

15-033-01 Puller, wheel hub

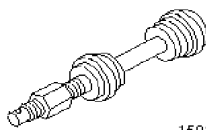

15033

15-033 Installer, wheel bearing

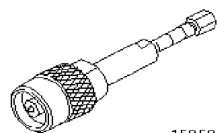

15050A

15-050A Remover, main tool

Proprietary Tools

Two-legged puller

Replace

1. Fit the brake shoes as described in «[Operation No. 12 285 3](#)».

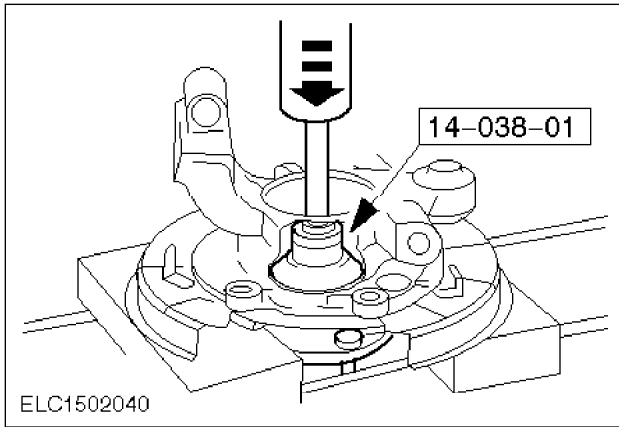

- 2. Press the wheel hub out of the stub axle.
Press the wheel hub out of the stub axle.

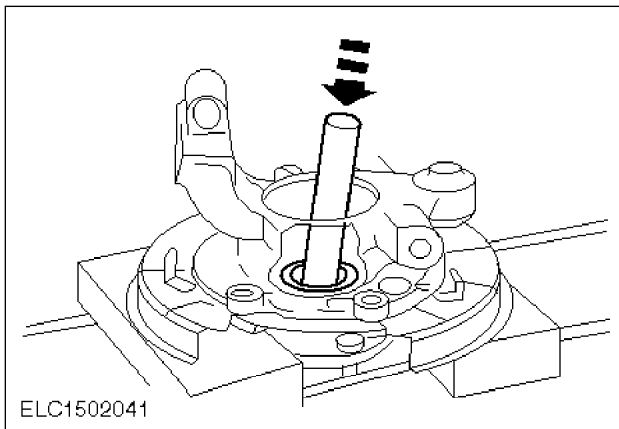

- 3. Remove the outer bearing cones.

Note:

The drift must be in perfect condition to avoid damage to the bearing seat.

- Drive the outer bearing cones out of the stub axle with a suitable brass drift.
- Remove all residual traces of grease from the stub axle.

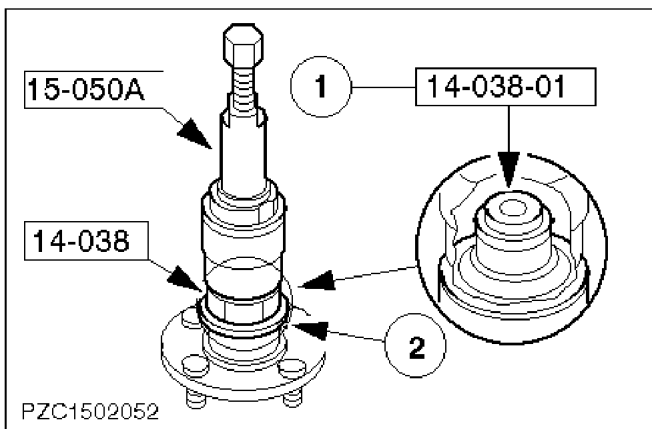

- 4. Remove the wheel bearings from the wheel hub.
Remove the bearing cage and the taper roller bearings.

- 1 Insert the thrust pad in the wheel hub.
- 2 Remove the outer bearing cone with the special tool.

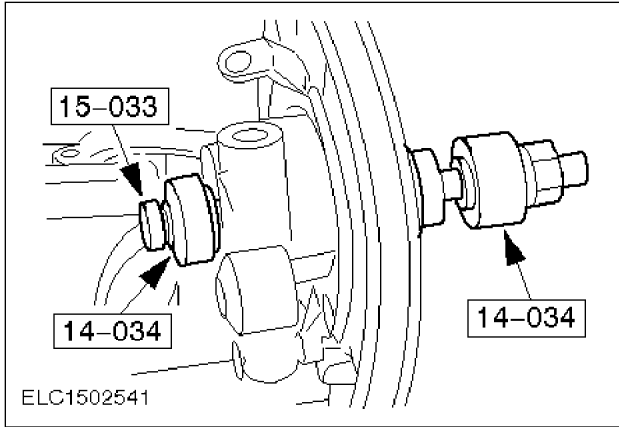

5. Draw the wheel bearings into the stub axle.

⚠ WARNING:
DO NOT PRESS THE BEARING UNIT APART (IT CANNOT BE REASSEMBLED).

Draw in the outer and inner bearing one after the other using the special tool.

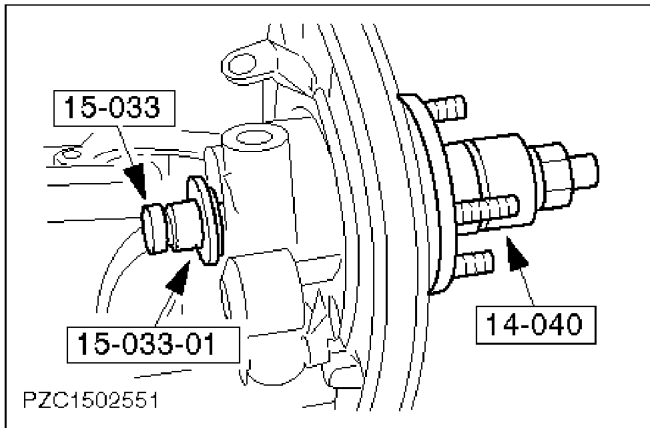

6. Draw in the wheel hub.

⚠ WARNING:
DO NOT HIT THE HUB, NOR USE A PRESS.

Draw in the wheel hub using the special tool.

7. Fit the brake shoes as described in [«Operation No. 12 285 4»](#).