

## Pump Assembly - Power Steering - Remove And Install (CVH and PTE) (13 434 0)

### Remove



#### CAUTION:

Disconnect the battery negative lead.

1. Raise the vehicle.

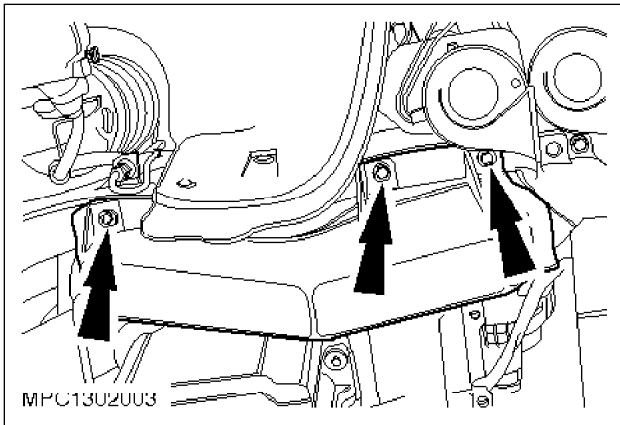

2. Remove the lower belt guard (three bolts).

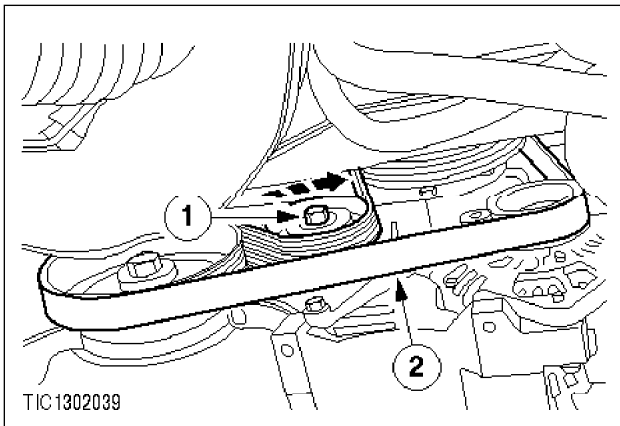

### Drive Belt - Power Steering Pump - Remove (13 424 0)

3. Remove the power steering pump drive belt.
  - 1 Rotate the belt tensioner in a clockwise direction.
  - 2 Remove the drive belt and release the belt tensioner.
4. Lower the vehicle.

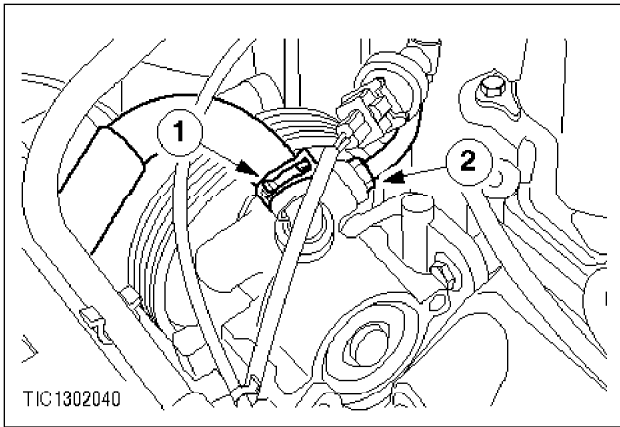

5. Disconnect the pipe and hose from the power steering pump.

- 1 Disconnect the low-pressure hose.
- Allow the fluid to drain into a suitable container.
- 2 Disconnect the high-pressure pipe.

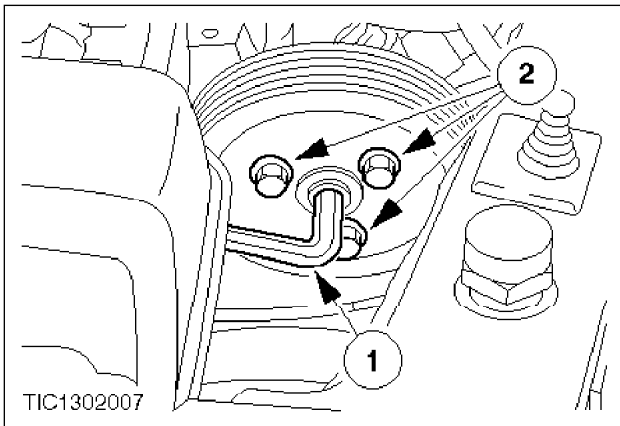

6. Remove the power steering pump pulley (three bolts).

- 1 Hold the centre of the pulley with an Allen key.
- 2 Remove the three pulley retaining bolts.

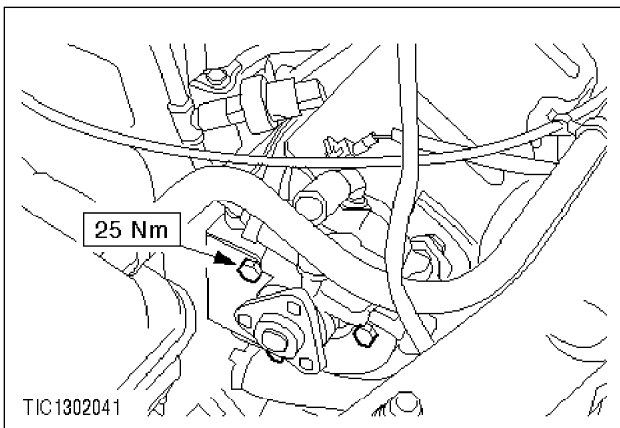

7. Remove the power steering pump.

- 1 Remove three retaining bolts from the front of the pump.
- 2 Remove one retaining bolt from the rear of the pump.

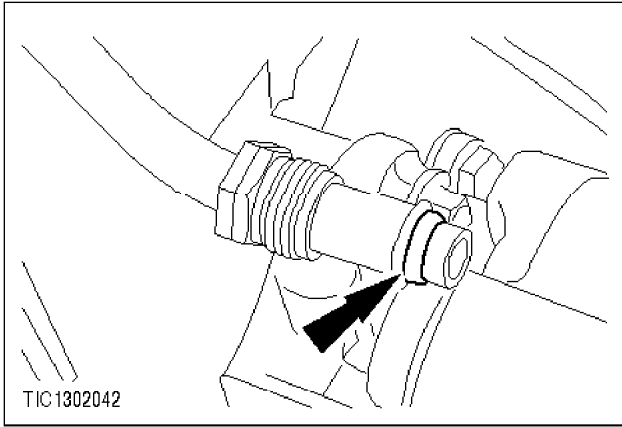

## Install

- 8. Renew the union O-ring.

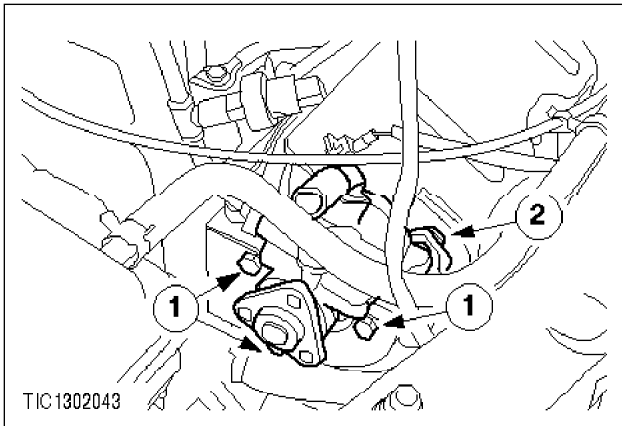

- 9. Refit the components in reverse order.

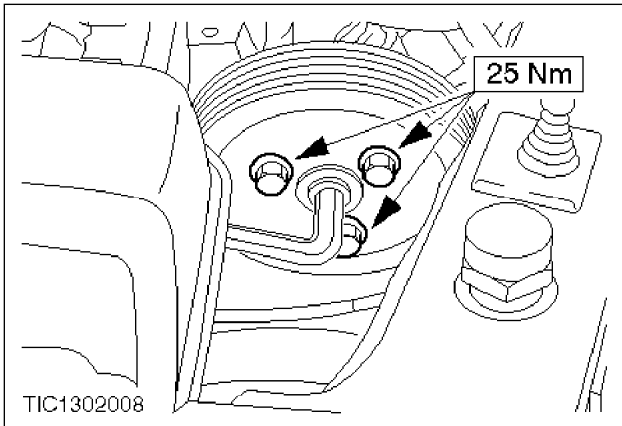

6

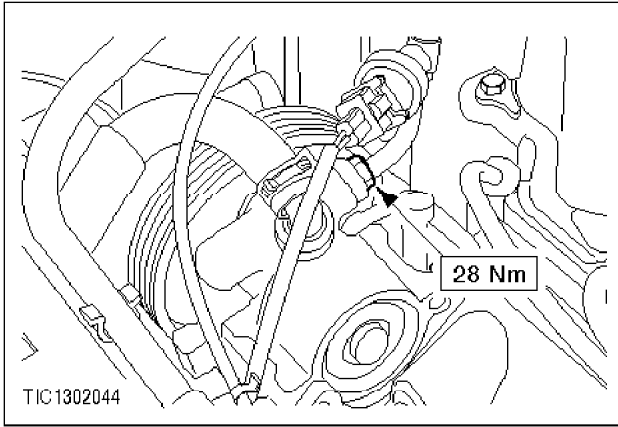

Ⓒ

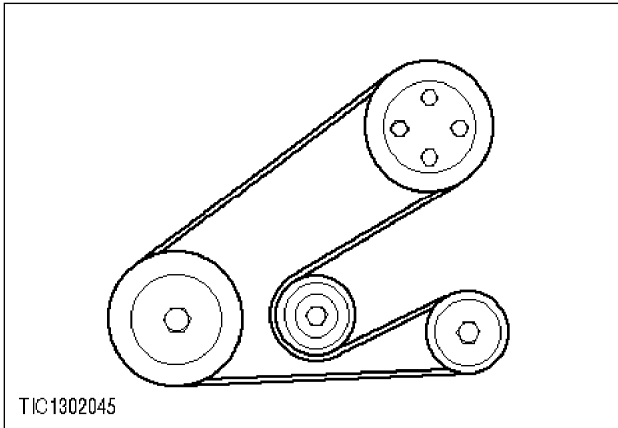

### Drive Belt - Power Steering Pump - Install (13 424 0)

Ⓒ

- 10 Bleed the power steering system (r«[Operation Number 13 4'5 1](#)»)
-